

OAK HILLS VILLAGE

14740 NW CORNELL RD. · PORTLAND · OR



PROPERTY HIGHLIGHTS

- 1,500, 1,401 & 1,260 SF Available
- \$28.00/NNN
- Located off Highway 26 in popular Sunset Corridor
- The center is near Cornell Oaks Corporate Park, Sunset High School, affluent Oak Hills and Bethany neighborhoods.
- Traffic count 23,608 ADT

DEMOGRAPHICS

	1 MILE	3 MILES	5 MILES
2024 POPULATION	14,688	134,100	299,285
2024 AVG. HH INCOME	\$123,167	\$130,561	\$119,450
2024 DAYTIME POPULATION	5,778	50,345	107,169

CONTACT:

DOUG MAGNUSEN doug@hsmppacific.com 503.245.1400 x516



OAK HILLS VILLAGE

14740 NW CORNELL RD. · PORTLAND · OR



OAK HILLS VILLAGE

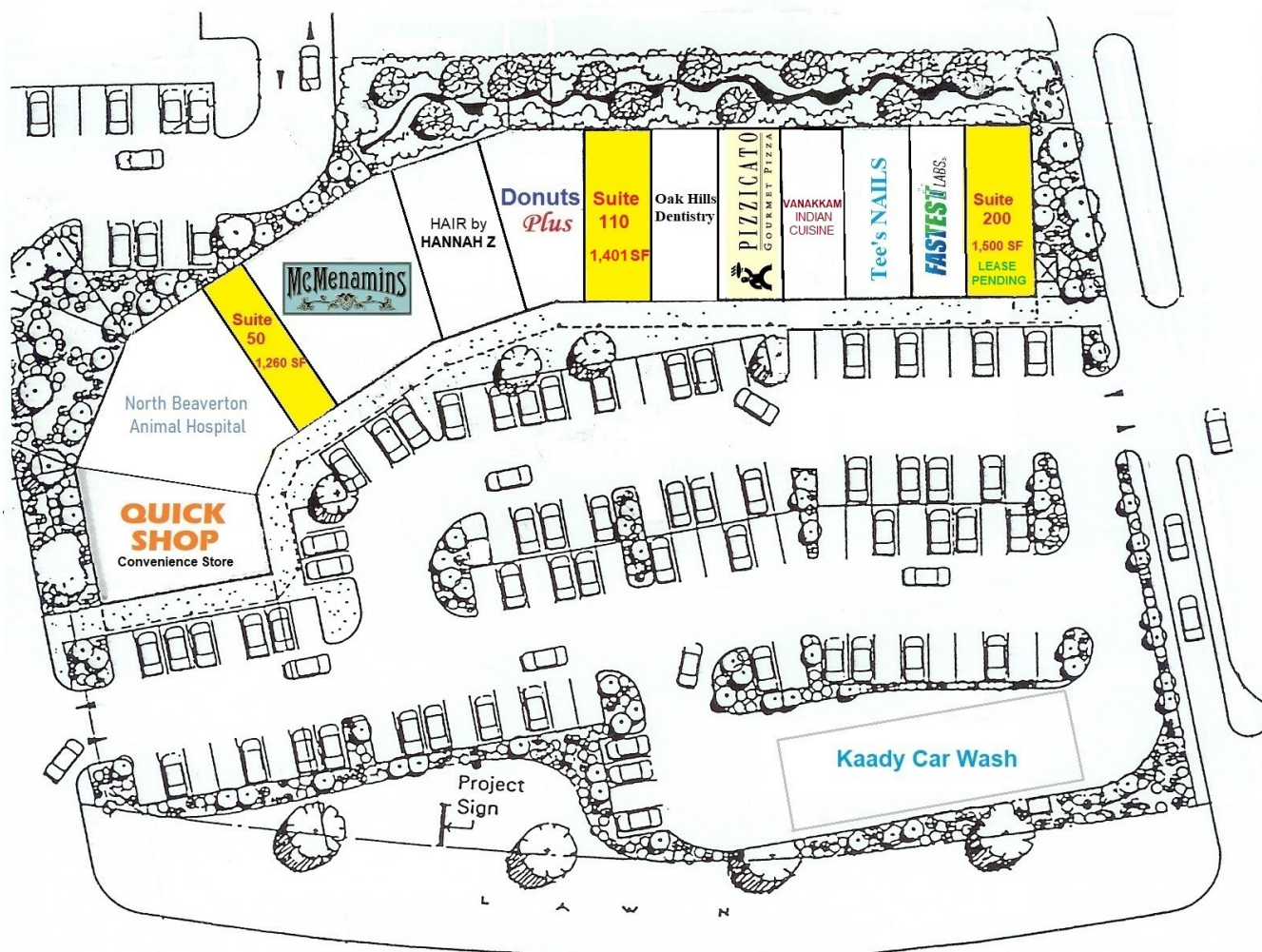

14740 NW Cornell Road

CONTACT:

DOUG MAGNUSEN doug@hsmPacific.com 503.245.1400 x516

